

TELECOMMUNICATIONS LICENSE AGREEMENT
INFORMATION PAGE (POP)

This page sets out information which is referred to and forms part of the TELECOMMUNICATIONS LICENSE AGREEMENT dated the **8th day of September, 2023** between **RIOCAN MANAGEMENT INC.** as authorized agent for **RIOKIM HOLDINGS (ONTARIO) INC.**, as the Licensors and **BELL CANADA** as the Licensee.

Land: The lands municipally known as **1111 Davis Drive, Newmarket, Ontario. L3Y 7V1**

Floor Area of Deemed Area: **1.5' square feet, in the main telephone room (MTR) – electrical room #2** as further detailed in Schedule "A". The exact measurement of the Deemed Area may be verified by an architect or surveyor employed by the Licensors for that purpose and upon verification, an adjustment of the License Fee and the floor area will be made retroactively to the Commencement Date.

Commencement Date: **8th day of September, 2023.**

Term: The period of ten (10) years commencing on the Commencement Date and expiring on **September 7, 2033.**

License Fee: **\$1,200.00** annually in advance due on the Commencement Date and each anniversary of the Commencement Date thereafter during the Term in connection with use of space in the Building.

Electrical Consumption Fee Estimate: **\$ 0** plus applicable sales taxes, to be paid annually in advance due on the Commencement Date and each anniversary of the Commencement Date thereafter.

Renewal Term: **One (1) period(s) of five (5) years.**

Notices:

Licensors

RIOKIM HOLDINGS (ONTARIO) INC.
c/o RioCan Management Inc.
700 Lawrence Avenue, Suite 445
Toronto, Ontario M6A 3B4
Attention: Legal

Licensee

c/o Brookfield Global Integrated Solutions
87 Ontario St. West, 6th Floor
Montreal, QC H2X 0A7
Attention: Department, Client Services; and
Department, Lease Administration
Fax: (514) 840-8404

with a copy to:

RioCan Management Inc.
c/o RioCan REIT, East GTA
157 Harwood Ave N., Unit C004
Ajax, Ontario L1Z 0A1

with a copy to:

Bell Canada Real Estate Services
87 Ontario St. West, 6th Floor
Montreal, QC H2X 1Y8
Attention: Director, Strategic Asset Planning
Fax: (514) 391-7990

TELECOMMUNICATIONS LICENSE AGREEMENT

This License Agreement made as of the 8th day of September, 2023.

B E T W E E N:

RIOCAN MANAGEMENT INC., as agent for RIOKIM HOLDINGS (ONTARIO) INC.,
(hereinafter the "Licensor")

- and -

BELL CANADA
(hereinafter the "Licensee")

1. DEFINITIONS

In this Agreement the capitalized terms appearing herein shall mean the following:

"Affiliate": means a company that is affiliated with another within the meaning of the Canada Business Corporations Act.

"Agreement": means this agreement, its Exhibits and Schedules and the Information Page.

"Black Out Period": in respect of each calendar year during the Term and any Renewal Term, means the period commencing on November 15 in each calendar year and ending February 1st of the following calendar year.

"Broadcasting": means any transmission of programs, whether or not encrypted, by radio waves or other means of telecommunication for reception by the public by means of any device.

"Building": means the building situated on the Lands.

"Business Day": means a day that is not Saturday, Sunday, or a statutory holiday in the Province in which the Lands are located.

"Cable": means fibre optic, coaxial, copper cables and wires.

"Commencement Date": means the date stated as the Commencement Date on the Information Page.

"Communications Equipment": means cabinets, racks, electronic equipment and other equipment that (i) has been installed in the Building by the Licensee or a corporate predecessor of the Licensee before the date of this Agreement, or (ii) from time to time will be installed by the Licensee in the Deemed Area, in each case, with the prior written approval of the Licensor in accordance with Section 7.

"Communications Spaces": means telecommunications pathways and cable pathways in the Building used by the Licensee to provide Services to Customers located in the Building, which pathways are: (i) designated by the Licensor, acting reasonably; and (ii) such other pathways used by the Licensee from time to time during the Term and any Renewal Term with the prior approval of the Licensor in accordance with Section 7.

"Connecting Equipment": means the Cables, fibre guides, fibre entrance cabinets, fibre patch panels, conduits, inner ducts and connecting hardware that is connected to the Entrance Cable, Main Distribution Frame, Communications Equipment or Cable or that is used to house or carry the Cable and (i) have been installed by the Licensee or a corporate predecessor of the Licensee before the date of this Agreement in the Building, or (ii) are described in Schedule "C" and are installed, or to be installed by the Licensee, through the Entrance Link, and the Communication Spaces in accordance with Schedule "C", and (iii) may be installed by the Licensee in the Building during the Term and Renewal Term with the prior written approval of the Licensor in accordance with Section 7.

"Consumer Price Index": means (All Items for Regional Cities, base year 1992=100) for the city in which the Building is located, or if there is no Consumer Price Index for that city, for the city in Canada nearest the Building for which there is a Consumer Price Index published by Statistics Canada (or by a successor or other governmental agency, including a provincial agency). If the Consumer Price Index is no longer published, an index published in substitution for the Consumer Price Index or any replacement index designated by the Licensor, acting reasonably, will be used. If a substitution is required, the Licensor will make the necessary conversions. If the base year is changed by Statistics Canada or the applicable governmental agency, the necessary conversions will be made.

"Cross Connection": means the connection of one wire or cable located in the Building under the management and control or ownership of one party to a wire or cable located in the Building under the management and control or ownership of another, by anchoring each wire or cable to a connecting block and placing a third wire between the two, or by any other means which complies with applicable law, and any other connection of the telecommunications system located in the Building or any of its components that is under the management, control or ownership of one party to that of another, or any of its components.

"CRTC": means the Canadian Radio-television and Telecommunications Commission, or any successor or replacement commission.

"Customer" means a tenant or occupant of premises in the Building who purchases or subscribes for services from the Licensee.

"Deemed Area": means the area described in Schedule "A".

"Electrical Consumption Fee" means a fee equal to the total cost of all electricity consumed in connection with the installation, operation and maintenance of the Licensee's Equipment, all as determined by the Licensor, acting reasonably, pursuant to Section 6.

"Entrance Cable": means the Cable installed or to be installed by the Licensee that connects the Licensee's telecommunications network from the property line of the Lands to the

Communications Equipment and to the Main Distribution Frame and includes the tie Cables between the Communications Equipment and the Main Distribution Frame.

"Entrance Link": means the coresleeve, or other penetration designated by the Licensor, acting reasonably, through the Building's foundation walls or elsewhere containing the Entrance Cable.

"Equipment Room": means the area containing the Main Distribution Frame for the Building.

"Event of Default": has the meaning given to such term in Section 19.

"Existing Equipment": means that part of the Licensee's Equipment installed before the Commencement Date.

"Fee": means any amount payable by the Licensee under this Agreement.

"Hazardous Substance": means any substance that is controlled by, regulated, or restricted under the laws of the Province in which the Building is situated or under the laws of Canada, including any regulations, guidelines, policy statements and restrictions pertaining to the protection of the natural environment, quality of air, water and other aspects of the environment and including but not limited to polychlorinated biphenals, asbestos, and other substances commonly referred to as pollutants, contaminants or hazardous substances.

"In-Building Wire": has the meaning given to such term by the CRTC and includes copper wires, Cable and other facilities which originate in the Equipment Room and run to the telephone closet on each floor of the Building and thereafter to but not within the premises of the Customers.

"Information Page": means the sheet attached to this Agreement as "Page IP".

"Inside Wire": means wires and other facilities which are usually in, or in proximity of, premises of a Customer, and which are under the Customer's responsibility and control.

"Lands": means the lands municipally described on the Information Page.

"LEC": means a local exchange carrier regulated by the CRTC.

"Licensee's Equipment": means the Communications Equipment and the Connecting Equipment.

"License Fee": means the annual sums stated as the License Fee on the Information Page in respect of the Licensee's use of space in the Building.

"Main Distribution Frame": means the main distribution frame or other physical location for the Cross Connection of a TSP's Entrance Cable to the In-Building Wire located in the Building.

"Multi-Dwelling Unit Building": has the meaning given to search term by the CRTC in Decision 2003-45 constituting a building with at least two units and at least one unit occupied by a tenant.

"Owner(s)": means the owner or owners from time to time of the freehold or leasehold title of the Lands, the Building or either of them.

"Plans and Specifications": means the working drawings, plans, specifications, and other applicable construction or installation plans referred to in Section 7(a).

"Prime": means the rate quoted from time to time as its "Prime Rate" for commercial loans by The Toronto Dominion Bank.

"Recoverable Costs": means the costs and expenses listed in on Schedule "D" for building services requested of the Licensor by the Licensee and such other costs and expenses incurred by the Licensor arising or resulting from or caused by the Licensee's construction and installation activities, in each case, relating to the provision of the Services in the Building. However, Recoverable Costs shall not include costs that: (i) would otherwise be incurred by the Licensor if the Licensee had not undertaken the construction and installation activities relating to the provision of the Services in the Building, (ii) costs that have already been incurred by the date of execution of this Agreement, (iii) costs associated with the negotiation, management, administration and monitoring of this Agreement or of other agreements with TSPs, and (iv) except for charges for costs and expenses identified in Schedule "D" in connection with services provided by the Riser Manager, fees in relation to a Riser Manager.

"Released Licensee Persons": means the Licensee and the officers, directors, employees, agents and contractors of the Licensee.

"Released Licensor Persons": means the Licensor, the Owner(s), the property manager of the Building and any lender that holds security on the Building or the Lands, and each of their respective officers, directors, employees, agents and contractors.

"Renewal Term": means the renewal term(s) noted on the Information Page.

"Riser Manager": means a person or entity retained by the Licensor to provide management and supervision services for all or part of the raceways, risers, ducts, conduits, sleeves, communications pathways (including the Communications Spaces), roof areas and other telecommunications related facilities in or serving the Building.

"Services": means the telecommunications or other communications services to be provided by the Licensee to Customers.

"Term": means the period of time stated as the term of this Agreement on the Information Page.

"TSP": means a telecommunications or other communications service provider.

2. GRANT

- (a) the Licensor grants to the Licensee for the Term and any Renewal Term, a non-exclusive license:
 - (i) to install, operate, maintain, repair, improve, replace, remove and supplement, in each case at the Licensee's sole expense and risk, the Entrance Cable, Communications Equipment, Connecting Equipment and Cable;

- (ii) to use the Entrance Link, Main Distribution Frame and Communications Spaces solely for the purposes set out in this Agreement;
- (iii) to connect the Entrance Cable to the Communications Equipment and to the Main Distribution Frame; and
- (iv) to connect the Licensee's Equipment to the In-Building Wire and Inside Wire,

in each case, solely to the extent required in connection with the Licensee's provision of the Services to the Customers.

- (b) The Licensee shall be provided access to the Lands and Building in order to exercise its non-exclusive license, twenty-four hours per day, three hundred and sixty five days per year subject to:
 - (i) the Licensor's reasonable security requirements;
 - (ii) the notice requirement as provided in Section 9(b);
 - (iii) an event of Force Majeure as provided in Section 32;
 - (iv) the rights of occupants and tenants of the Building;
 - (v) Licensor's reasonable rules and regulations, as same may be amended from time to time; and
 - (vi) all applicable laws and other government requirements including fire and building code regulations.
- (c) The Licensee shall use the Equipment Room and Deemed Area for the sole purpose of providing Services to the Customers. The Licensee is not permitted to use the Lands, Building or any part thereof or any equipment, cabling, wires, pathway or connections in any way to provide telecommunications or other communication services to other customers or persons occupying space located outside of the Building.
- (d) The Licensor may at any time, require the Licensee, to relocate within the Building any or all of the Licensee's Equipment and/or the Deemed Area. Upon receipt of not less than one hundred and twenty (120) days advance written notice from the Licensor (a "**Relocation Notice**") the Licensee shall relocate the Licensee's Equipment and/or the Deemed Area, as the case may be, to the location within the Building specified by the Licensor. If the Relocation Notice requires the relocation of the Licensee's Equipment and/or the Deemed Area to occur within the first two (2) years after the Commencement Date, the Licensor will be solely responsible for the direct, reasonable, out of pocket expenses incurred by the Licensee to relocate the Licensee's Equipment and/or the Deemed Area (the "**Relocation Costs**"), and if the Relocation Notice does not require the relocation of the Licensee's Equipment and/or the Deemed Area to occur until after that two (2) year period, the Relocation

Costs will be shared equally by the Licensor and the Licensee unless the relocation is primarily required to accommodate another TSP in which case, the Licensee will not be required to pay any part of the Relocation Costs. The Licensor shall permit the Licensee to effect any relocation of the Licensee's Equipment and/or the Deemed Area using a procedure that will ensure that the relocated Licensee's Equipment is operational for providing Services to the Customers prior to discontinuing Service to the Customers from the previous service location. If a Relocation Notice is delivered, the Licensee, will, within fifteen (15) days after its receipt deliver written notice to the Licensor setting out particulars of its estimate of the Relocation Costs, and the Licensor will be entitled to rely upon that estimate in proceeding with the relocation of the Licensee's Equipment and/or the Deemed Area; notwithstanding the provisions of this Section 2(d), the Licensor shall not be responsible for any Relocation Costs in excess of the amount (or its 50% share of the amount) set out in the Licensee's estimate. The Licensor may at any time within fifteen (15) days after receipt of the Licensee's estimate of the Relocation Costs rescind its Relocation Notice by giving written notice to the Licensee to that effect.

- (e) The Licensor makes no warranty or representation that the Equipment Room, Deemed Area, the Communications Spaces or any part of the Building is or are suitable for the Licensee's use.
- (f) The Licensor may grant, renew or extend licenses to other TSPs. The License granted by this Agreement is revocable only in accordance with the express terms of this Agreement.
- (g) The Licensee agrees to assist the Licensor in improving the space and operating efficiencies within the Building by undertaking the following, at the Licensee's cost, at the request of the Licensor and within timeframes approved by the Licensor, acting reasonably:
 - (i) identifying Existing Equipment;
 - (ii) upon reasonable request from the Licensor, examining, identifying and labelling specific items of Existing Equipment;
 - (iii) subject to Section 2(d), relocating and reconfiguring the Existing Equipment; and
 - (iv) upon request from the Licensor and with reasonable time to respond in the circumstances, providing to the Licensor its existing available information on its Existing Equipment, e.g. types of wiring, wiring casings, materials used in the Existing Equipment, sizes, capacities and other information, where that other information may be required having regard to building code, building safety, fire code, fire safety or similar governmental requirements or the requirements of the Licensor's insurers.
- (h) The relationship between the Licensor and the Licensee is solely that of independent contractors, and nothing in this Agreement shall be construed to

constitute the parties as employer/employee, partners, joint venturers, co-owners or otherwise as participants in a joint or common undertaking.

3. FEES

- (a) The Licensee agrees to pay the License Fee for use of the space in the Building to the Licenser annually in advance without any set-off, deduction or abatement whatsoever in accordance with the Information Page.

The Licensee also agrees to pay the Electrical Consumption Fee (if applicable pursuant to Section 6 below) to the Licenser annually in advance without any set-off, deduction or abatement whatsoever in accordance with the Information Page.

- (b) The Licensee shall also pay to the Licenser any Recoverable Costs incurred by it within thirty (30) days after receipt of each itemized invoice, without deduction or set off.
- (c) Interest will accrue at that rate of interest that is three percent (3%) greater than Prime on any arrears of Fees payable by the Licensee, and will be payable when payment of the interest is demanded.
- (d) Value added taxes and similar taxes such as "HST" or "GST" (including, without limitation) are payable by the Licensee on all Fees.

4. TERM - OPTION TO RENEW

- (a) The Term of this Agreement starts on the Commencement Date and expires on the date stipulated on the Information Page.
- (b) Provided that the Licensee is not then in default beyond applicable cure periods of any of its obligations under this Agreement, this Agreement will automatically be renewed for the Renewal Term(s) unless the Licensee gives the Licenser at least one hundred and twenty (120) days written notice prior to the end of the Term of the Licensee's intention not to renew. Each Renewal Term will be governed by the same terms and conditions set out herein except for: (i) any further right to renew, and (ii) the License Fee, which will increase at the start of each Renewal Term by a percentage equal to the percentage of the increase in the Consumer Price Index from the Commencement Date or start of the previous Renewal Term (if any) as the case may be, to the start of the applicable Renewal Term.

5. USE

The Licensee shall use the Communications Spaces, Deemed Area and the Equipment Room in the Building solely for the purpose of providing Services to the Customers. The Licensee must be properly certified or licensed by the appropriate governing bodies to provide the Services. This Agreement does not provide for the installation or operation of any forms and types of rooftop communications equipment or wireless communications equipment or Broadcasting.

6. ELECTRIC UTILITIES

The Licensor shall estimate, acting reasonably, the annual amount of the Electrical Consumption Fee and deliver details of same to the Licensee on or prior to **sixty (60)** days in advance of the each annual anniversary of the Commencement Date. At the Licensor's request, Licensee will provide Licensor with an electrical load calculation for Licensee's Equipment, prior to installation or from time to time during the Term, to determine the total estimated annual cost of all electricity consumed in connection with the installation, operation and maintenance of the Licensee's Equipment. If the electrical load calculation indicates that Licensee's Equipment does not consume hydro, then the Electrical Consumption Fee may be waived by the Licensor, at its sole discretion. If the electrical load calculation indicates that Licensee's Equipment is consuming hydro then such estimated annual cost shall be paid by the Licensee annually in advance in accordance with the Information Page. Licensor has the right to audit Licensee's Equipment at any time to ensure that the Licensee's power consumption is in accordance with its estimated electrical load calculation and may adjust the Electrical Consumption Fee charged in accordance with such audit. Alternatively, where feasible, the Licensee may install a meter at its cost (and as approved by the Licensor in accordance with Section 7) and in that case it will pay for its electricity consumption directly to the utility supplier.

Alternatively, the Licensor may require the Licensee to be responsible for contracting with and procuring all electrical services, if any, which are necessary for the Licensee's Equipment. Licensee shall pay for all costs of meters, sub meters, wiring, risers, transformers, electrical panels, lighting, air conditioning and other items, if any, required by Licensor which in Licensor's sole judgement, are necessary to accommodate Licensee's design loads and capacities, including, without limitation, the installation, operation and maintenance thereof. Notwithstanding the foregoing, Licensor may withhold consent for Licensee's installation of any wiring, risers, transformers, electrical panels, lighting, air conditioning systems, or other equipment if, in Licensor's sole judgement, acting reasonably, the same are not necessary or would cause damage or injury to the Building or cause or create a dangerous or hazardous condition or entail excessive or unreasonable alterations or repairs to the Building, or would interfere with or create or constitute a disturbance to other TSPs, tenants or occupants of the Building. In no event shall Licensor incur any liability for Licensor's refusal or withholding of consent for Licensee's installation or modification of, any such electrical facility or Licensee's Equipment.

Licensor shall notify Licensee in advance of any planned utility outages that may interfere with Licensee's Equipment use but shall not be responsible for any losses, costs or expenses suffered as a result of any such outages provided that no less than **fifteen (15)** days' notice of such planned utility outages was provided. Licensor has no obligation to provide emergency or "backup" power to Licensee. Any provision of emergency or "backup" power shall be the sole responsibility of, and at the sole cost of, the Licensee.

7. CONSTRUCTION TO INCLUDE COSTS FOR 3RD PARTY REVIEW OF DRAWINGS BY A TELECOM CONSULTANT (RECOMMENDATION RYCOM)

- (a) Subject to what is stated below and as outlined in Schedule "E" Scope of Work, prior to performance of any work in the Building, the making of any installation in the Building, and any changes, alterations, removals or upgrades to any existing work or installation in the Building (collectively, the "**Licensee Work**"), the

Licensee shall, at its sole cost and expense, prepare and deliver to the Licensor working drawings, plans and specifications for the Licensee Work detailing the type, size and location of the Licensee's Equipment that is proposed to be installed, changed, altered, upgraded or removed, the Communication Spaces to be used by the Licensee and the Deemed Area, all specifically describing the proposed Licensee Work. All working drawings, plans and specifications must be prepared in accordance with applicable engineering standards, and will be considered as part of the Plans and Specifications when they have been approved by the Licensor, in writing. No Licensee Work shall commence until the Licensor has approved, in writing, the working drawings, plans and specifications, and any other applicable construction or installation plans. The Licensor's approval of Plans and Specifications is not deemed a representation that the Licensee's Equipment will not cause interference with other systems in the Building, nor that the Plans and Specifications comply with applicable laws, rules or regulations or the Codes, Standards and Guidelines attached in Schedule "C", as same may be amended or updated by the Licensor from time to time. That responsibility shall remain with the Licensee. Despite what is stated above, only an initial "Bay Layout" will be required in respect of equipment intended to be installed in the racks installed inside the Deemed Area and, technical specifications in respect of that equipment will not be required to be provided other than specifications relating to heat generated by the equipment venting and/or cooling of such heat and electrical consumption;

- (b) The Licensee warrants that (other than the Existing Equipment) the installation of the Licensee's Communications Equipment, Connecting Equipment, Entrance Cable, Cable and all Licensee's Work shall be in completed in strict compliance with the approved Plans and Specifications.
- (c) The Licensee agrees that all Licensee Work shall be performed:
 - (i) in a neat, responsible, and good and workmanlike manner;
 - (ii) strictly consistent with such reasonable requirements as shall be imposed by the Licensor and communicated in advance to the Licensee in writing;
 - (iii) in accordance with all applicable laws, rules and regulations and the Codes, Standards and Guidelines attached in Schedule "C", as same may be amended or updated by the Licensor from time to time; and
 - (iv) using only contractors approved in advance, in writing by the Licensor (it being acknowledged that, without limitation, a lack of or incompatible union affiliation of a contractor is a reasonable basis for Licensor's refusal to approve a contractor).
- (d) The Licensee shall label each Cable installed by the Licensee on or after the date of this Agreement in the Communications Spaces, in each telephone closet through which the Cables pass, and, in addition, at any intervals and at additional locations that the Licensor might reasonably require. The labelling will be in a format approved by the Licensor acting reasonably.

- (e) The Licensee shall obtain, at its sole cost and expense, prior to commencing the Licensee Work any necessary permits, licenses and approvals, copies of which will be delivered to the Licensor prior to commencement of the Licensee Work. The Licensee's Equipment shall comply with all applicable standards including safety, as may be periodically revised by any governing body with jurisdiction over the Licensee's operations.
- (f) The Licensee shall not, during the performance of the Licensee Work or otherwise block access to or in any way obstruct, interfere with or hinder the use of the Building's common areas, loading docks, halls, stairs, elevators, the sidewalks around the Building or any entrance ways.
- (g) The Licensee may amend or supplement the Plans and Specifications approved by the Licensor, from time to time, with the prior written consent of the Licensor, for the purpose of providing the Services to the Customers. All terms and conditions of this Section 7 shall apply to amended Plans and Specifications.
- (h) Prior to the installation of any additional Licensee's Equipment under this Agreement, the Licensee will also provide to the Licensor whatever information the Licensor reasonably requires concerning types of wiring casings, materials used in the Licensee's Equipment, sizes, capacities and other information which may be required having regard to building code, building safety, fire code, fire safety or similar governmental requirements or the requirements of the Licensor's insurers. From time to time at reasonable intervals, the Licensor may require the Licensee to update the information referred to above in connection with the Licensee's Equipment and the Licensee will complete the update by confirmation in writing no later than ten (10) Business Days after written request.
- (i) Notwithstanding anything to the contrary contained in this Agreement, in no event shall Licensee's Work or removal of equipment as provided in section 20 be carried out during a Blackout Period.

In the event of a conflict between this Agreement and Schedule "E" Scope of Work, this Agreement shall prevail.

8. COVENANTS

- (a) The Licensee covenants as follows:
 - (i) The Licensee shall, at its sole cost and expense, maintain and repair the Deemed Area and the Licensee's Equipment in proper operating condition and maintain them in satisfactory condition as to safety and in accordance with all applicable laws, rules and regulations and the Codes, Standards and Guidelines attached in Schedule "C", as same may be amended or updated by the Licensor from time to time.
 - (ii) The Licensee shall, at its sole cost and expense, repair any damage to the Lands, Building, Communications Spaces and any other property owned by the Licensor or by any lessee or licensee of the Licensor or by any other

occupant of the Building or the Lands where such damage is caused by the Licensee or any of its agents, representatives, employees, contractors, subcontractors, invitees or those other persons for whom the Licensee is at law responsible. If the Licensee fails to repair or refinish the damage, upon thirty (30) day's prior written notice or such other period as is reasonably required to cure the default provided Licensee commences to cure expeditiously and diligently proceeds with such repair or refinishing, the Licenser may repair or refinish such damage and the Licensee shall reimburse the Licenser, on demand, for all costs and expenses incurred in such repair or refinishing, plus an administration fee equal to fifteen percent (15%) of those costs.

- (iii) The Licensee shall not interfere with the use and enjoyment of the Building by the Licenser or by lessees, or licensees of the Licenser or tenants or occupants of the Building or other buildings. If such interference occurs, the Licenser may give the Licensee written notice thereof and the Licensee shall correct same as soon as possible but not more than forty-eight (48) hours after receipt of notice. If the Licensee fails to correct the conditions after proper notification, the Licenser may take any action the Licenser deems appropriate to correct the conditions, all at the cost of the Licensee, plus an administration fee equal to fifteen percent (15%) of those costs. The Licensee shall, on demand, reimburse the Licenser for all costs incurred by the Licenser and make payment of the administration fee.
- (iv) The Licensee's Equipment shall not disrupt, adversely affect, or interfere with other TSPs, the Building's operating, elevator, safety, security, or other systems, or with any tenant's or occupant's rights of enjoyment, including their respective use or operation of communications or computer devices or with the systems, facilities, and devices situated in neighbouring properties. The Licensee shall correct such interference as soon as possible but not more than forty-eight (48) hours after receiving written notice of such interference failing which Licenser shall have the option to take any reasonable action it deems appropriate in the circumstances (the costs of which shall be payable by the Licensee, plus an administration fee equal to fifteen percent (15%) of those costs. The Licensee shall, on demand, reimburse the Licenser for all costs incurred by the Licenser and make payment of the administration fee.
- (v) The Licensee will comply with all Building rules, as periodically adopted by the Licenser acting reasonably, and will cause its agents, employees, contractors, invitees and other persons for whom the Licensee is at law responsible to comply with such Building rules.
- (vi) The Licensee will comply with all applicable laws, rules and regulations periodically issued by any and all governing bodies pertaining to the installation, maintenance, operation and repair of the Deemed Area, the Equipment Room, the Licensee's Equipment and In-Building Wire, including the Licensee's provision of Services and with the Codes,

Standards and Guidelines attached in Schedule "C", as same may be amended or updated by the Licensors from time to time.

- (vii) The Licensee will not encumber, charge, grant a security interest in respect of, or otherwise grant rights in favour of third parties in respect of any part of the In-Building Wire or any other Licensee's Equipment. Despite the foregoing, the Licensors acknowledge and agree that the Licensee is permitted to allow other local exchange carriers to connect to and use copper In-Building Wire under its responsibility and control and conversely, to connect to and use copper In-Building Wire under the control and responsibility of other TSPs, at no cost.
- (viii) Subject to Schedule "B", except as required or mandated by the CRTC, the Licensee will not permit any other TSP to co-locate equipment in its Deemed Area nor will it permit any TSP to Cross Connect to any of the Licensee's Equipment or to use any part of the Licensee's Equipment for the purpose of providing telecommunication or other communication services to customers in the Building.
- (ix) The Licensee will not use any part of the Licensee's Equipment as a network hub facility, switch hotel, switch node, or similar facility that functions as an integral part of a network where disruption of the operation or use of the Licensee's Equipment or any part of it would have the effect of disrupting service to persons outside of the Building.
- (x) The Licensee will strictly comply with all occupational health and safety legislation, Workers' Compensation legislation, and other applicable laws, rules and regulations relating to performance of the Licensee Work and adherence to safety standards, as applicable.
- (xi) If the Licensors elect to retain a Riser Manager, the Licensee will, to the extent directed by the Licensors (i) recognize the Riser Manager as the duly authorized representative of the Licensors, and (ii) abide by all reasonable policies, directions and decisions of the Riser Manager pertaining to use of the raceways, risers, ducts, conduits, sleeves, communications pathways (including the Communications Spaces), roof areas and other telecommunications related facilities in or serving the Building and the installation and operation of Licensee Equipment having regard to safety, operational and building integrity concerns. Notwithstanding the foregoing, unless agreed to in writing by the Licensee in its sole discretion, the Licensee shall not be required to use the services of any Riser Manager or any other third party for any In-Building Wire but Licensee shall follow requirements of any Riser Manager.

(b) The Licensors covenants:

- (i) To operate, repair and maintain the Building and building systems and the Lands in a safe and proper operating condition and in accordance with accepted building industry standards;
- (ii) That any consent or approval of the Licensor pursuant to the terms of this License shall not be unreasonably withheld, conditioned or delayed, except as is expressly provided for in this Agreement;
- (iii) Subject to the Licensee reimbursing the Licensor for the Licensor's reasonable costs in doing so, and subject to payment to the Licensor of an administration fee of fifteen percent (15%) of those costs, to cooperate with the Licensee to the extent reasonable in obtaining all necessary consents, permits and authorizations as may be required for the Licensee Work and for all other construction, installation and operations conducted by the Licensee on the Lands and in the Building; and
- (iv) If the operation of the Licensee's Equipment or the provision of the Services is interfered with by the operation of other equipment or by the activities of third parties in or in respect of the Building, the Licensor shall, to the extent that it is commercially reasonable, upon being provided by the Licensee with written notice and reasonable particulars concerning the nature of the interference, use reasonable efforts (without the expenditure of funds) to assist the Licensee in removing or minimizing the interference within a time frame that is reasonable having regard to the nature and extent of the interference.

9. ACCESS

- (a) Subject to the conditions in Section 2(b) and to Section 7(i), the Licensee's authorized representatives may have access to the Equipment Room at all times during normal business hours, and at other times as agreed to by the parties in advance, for the purposes of installing, maintaining, operating, improving and repairing the Licensee's Equipment. Subject to the conditions in Section 2(b) and to Section 7(i), the Licensor will give the Licensee's authorized employees or properly authorized contractors, subcontractors, and agents of the Licensee ingress and egress to the Lands, Building and Communications Spaces including non-exclusive use of an elevator during normal business hours, and at other times as agreed to by the parties in advance. However, only authorized engineers, employees or properly authorized contractors, subcontractors, and agents of the Licensee, authorized regulatory inspectors, or persons under their direct supervision and control will be permitted to enter the Building, Communications Spaces, Equipment Room, or other areas in the Building and only upon the conditions set forth in this Agreement. The Licensee shall be fully responsible for the acts or omissions of its employees or other authorized persons invited on its behalf to enter the Communication Spaces, Equipment Room, or other areas in the Building or on the Lands.

- (b) Except in the event of an emergency and as described below, the Licensee will give at least twenty four (24) hours prior written notice to the Licensor of its intent to enter Communications Spaces. At the time that notice is given, the Licensee shall inform the Licensor of the names of the persons who will be accessing the Communications Spaces, the reasons for entry, and the expected duration of the work to be performed. For routine service activations and repair visits to the Building during normal business hours for which purposes the Licensee requires access without advance notice in order to meet its CRTC mandated service provisioning and service repair intervals this notice may be given at the time of the entry, to the security person, or other person designated for that purpose by the Licensor. Any person who accesses the Communication Spaces, or any other part of the Building outside of normal business hours, may be required by the Licensor to be accompanied by a representative of the Licensor designated for that purpose and the cost of providing this form of accompaniment or supervision (unless such escort is already on-site and being paid in the ordinary course) will be paid by the Licensee to the Licensor based on hourly wage and the employment cost plus an administration fee of fifteen percent (15%). This escort fee shall not apply if it is recovered from the Customers through the operating costs of the Building charged to the Customers under their leases. In the event of any emergency, the Licensee shall give to the Licensor as much advance notice as reasonably possible of its intent to enter the Communications Spaces and, within five (5) Business Days following the entry, shall provide to the Licensor a written report detailing the nature of such emergency, the corrective actions taken, and any other relevant information.
- (c) Nothing in this Agreement shall prohibit or otherwise restrict the Licensor and its representatives from having access to and to enter upon and into the Equipment Room or any Deemed Area for the purpose of inspections, conducting maintenance, repairs and alterations which the Licensor wishes to make in connection with the Building, or to perform any acts related to the safety, protection, preservation, or improvement of the Equipment Room, Deemed Area, or the Building or for such other purposes as the Licensor considers necessary. The Licensor will, however, except in case of an emergency, give the Licensee at least twenty-four (24) hours advance notice before entry into the Deemed Area and will be accompanied by a representative of the Licensee if the Licensee makes a representative available for that purpose within forty-eight (48) hours of the Licensee's receipt of the Licensor's notice.

10. INSURANCE

- (a) The Licensee shall maintain in force, at its expense, during the Term of this Agreement and any Renewal Term, a policy of Commercial General Liability Insurance issued by an insurer acceptable to the Licensor, acting reasonably, insuring the Licensee and, as additional insureds, the Licensor, the Owner(s), any property manager or any lender that holds security on the Building that the Licensor may reasonably designate by written notice, only in respect of matters related to the operations of the Licensee in the Building, with a combined single limit of at least Ten Million Dollars (\$10,000,000.00) per occurrence for bodily injury or death or physical damage to tangible

property including loss of use, physical damage to the Building and tangible property of the Licensors in the Building or bodily injury or death of the Licensors' employees, or bodily injury or death or physical damage to tangible property suffered by any of the customers of the Licensee and their employees in the Building. The Licensee's liability insurance may be composed of any combination of a primary policy and an excess liability or "umbrella" insurance policies, will contain owners' and contractors' protective coverage, standard non-owned automobile coverage, contingent employer's liability insurance, a cross liability and severability of interests clause, and be written on an occurrence basis.

(b) The Licensee will also maintain (i) an automobile liability insurance policy, and (ii) all risk property insurance on the Licensee's Equipment with a sufficient insured limit to cover its replacement cost and with a waiver of subrogation against the Licensors from the property insurers or, alternatively, the Licensee may self insure for the full replacement cost of the Licensee's Equipment.

(c) The Licensee's Commercial General Liability insurance shall be primary insurance insofar as the Licensors, and the Licensee are concerned, with any other insurance maintained by the Licensors being excess and non-contributing with the insurance of the Licensee required hereunder with respect to the extent of the negligence of Licensee and those over whom it is responsible in law.

(d) The Licensee shall provide proof of such insurance to the Licensors prior to commencement of any construction and notify the Licensors, in writing, that a policy is cancelled or materially changed to the detriment of the Licensors at least thirty (30) days prior to such cancellation or material change. Annually, on the anniversary of the Commencement Date, or upon renewal of the respective policies as the case may be, the Licensee shall provide proof of such insurance in the form of insurance certificates signed by the Licensee's insurance brokers or its insurers' authorized representatives and in form, content, and detail consistent with the standard developed by ACORD (Association of Cooperative Operations, Research and Development) to the Licensors, acting reasonably.

(e) The Licensors will maintain all risk property insurance on the Building.

(f) The Licensee will obtain, if applicable, boiler and machinery insurance on a repair and replacement basis on all equipment owned or leased by the Licensee or owned by others, but in the care, custody or control of Licensee and located within the Equipment Room.

11. RELEASE BY LICENSEE

In no event will the Licensors be liable to the Licensee for:

- (a) any damage to the Licensee's Equipment, Equipment Room, and Deemed Area or loss of, or use of such property;
- (b) the quality, adequacy, compatibility or sufficiency of any Communication Spaces, Cross Connection, Entrance Link, Deemed Area, Equipment Room, In-Building Wire, Inside Wire or other portion of the Building provided to the Licensee hereunder, it being acknowledged by the

Licensee that all Building Communication Spaces are provided "as is" and "where is", the use of which is at the sole risk of the Licensee;

(c) the activities of any third party, under the terms of another telecommunications access license or similar agreement, whether or not the party has been escorted while within the Building;

(d) any claims resulting from lightning or other electrical current passing through the Building or facilities that cause any damage to the Licensee's Equipment or result in the interruption of any Service by the Licensee; or

(e) the inadequacy of any utility service, or the loss of or the failure to provide any utility service save and except for the failure of the Licensor to provide reasonable prior written notice in accordance with Section 6. The Licensee acknowledges that interruptions in the supply of any services, systems or utilities are not uncommon and the Licensee further acknowledges that any sensitive Licensee Equipment in and on the Building will be protected by the Licensee from any failure in supply or interruptions through the use of a UPS system, surge protectors and other appropriate safety systems.

12. MUTUAL RELEASE

Notwithstanding anything to the contrary in this Agreement:

(a) Subject to subsections (b) and (c), each of Licensor and Licensee hereby releases the other and waives all claims against the other and those for whom the other is in law responsible with respect to occurrences insured against or required to be insured against by the releasing party, whether any such claims arise as a result of the negligence or otherwise of the other or those for whom it is in law responsible.

(b) Such release and waiver shall be effective only to the extent of proceeds of insurance received by the releasing party and proceeds which would have been received if the releasing party obtained all insurance required to be obtained by it under this Agreement and for this purpose deductible amounts shall be deemed to be proceeds of insurance received.

(c) Notwithstanding anything to the contrary in this section, Licensor and Licensee shall each be liable to any third person (being any person other than Licensor or Licensee) to the extent of their respective fault or negligence and each shall be entitled to full indemnity and contribution from the other to the extent of the other's fault or negligence.

13. MUTUAL INDEMNITY

To the extent not released under Section 12, each party shall indemnify and save harmless the other from all liabilities, damages, losses or expenses arising out of:

(a) any breach by the indemnifying party of any covenant or condition in this Agreement;

(b) any loss, cost or expense arising from or occasioned by the act, fault or negligence of the indemnifying party, its officers, agents, servants, employees, contractors, customers, invitees or licensees.

Such indemnity shall survive the termination of this Agreement, anything in this Agreement to the contrary notwithstanding.

14. LIENS

The Licensee shall be responsible for the satisfaction or payment of any liens for any provider of work, labour, material or services claiming by, through or under the Licensee. The Licensee shall also indemnify, hold harmless and defend the Licensors and Owner(s) against any such liens, including the reasonable fees of the Licensors' solicitors. The provisions of this Section shall survive termination of this Agreement. All such liens shall be removed within five (5) Business Days of notice to the Licensee to do so. The Licensors may, at the cost of the Licensee, pay money into court to obtain removal of a lien if the Licensee fails to do so, as required, and the Licensee will pay the cost to the Licensors including the amount paid into Court, plus an administration fee equal to fifteen percent (15%) of such amounts as are paid by the Licensors.

15. CONSEQUENTIAL DAMAGES - EXPANDED MEANINGS - AGENCY AND TRUST

(a) Neither the Licensors nor the Released Licensors Persons nor the Licensee nor the Released Licensee Persons will be liable to the other (regardless of any other provision of this Agreement), in respect of any indirect, special, incidental or consequential damages of Licensors, Released Licensors Persons, Licensee or Released Licensee Persons, including loss of revenue, loss of profits, loss of business opportunity or loss of use of any facilities or property, even if advised of the possibility of such damages and whether or not such loss or claim may have arisen out of the negligence (including, without limitation, gross negligence) of the Licensors, Released Licensors Persons, the Licensee or any Released Licensee Persons.

(b) Wherever a release is provided for under this Agreement in favour of the Licensors, it will be deemed to include the Released Licensors Persons. The Licensors act as agent or trustee for the benefit of the Released Licensors Persons, and each of them, to allow them to enforce the benefit of this provision as well as the benefit of each release clause in this Agreement that is intended to benefit them.

(c) Wherever a release is provided for under this Agreement in favour of the Licensee, it will be deemed to include the Released Licensee Persons. The Licensee acts as agent or trustee for the benefit of the Released Licensee Persons, and each of them, to allow them to enforce the benefit of this provision as well as the benefit of each release clause in this Agreement that is intended to benefit them.

16. ASSUMPTION OF RESPONSIBILITY AND CONTROL

The Licensors reserve its right, consistent with the applicable decisions and rulings of the CRTC, to request the Licensee to transfer responsibility and control of its In-Building Wire. Such transfer shall be at the sole discretion of the Licensee and on terms and conditions acceptable to the Licensee. If the Licensors assume responsibility and control of In-Building Wire installed by the Licensee, it will be entitled to recover the reasonable costs of its maintenance and management to the extent permitted by the CRTC.

17. ASSIGNMENT, SUBLICENSING, ENCUMBERING, SHARING OF SPACE AND EQUIPMENT BY THE LICENSEE

- (a) The Licensee shall not assign this Agreement in whole or in part without obtaining the prior written consent of the Licenser which consent may not be unreasonably withheld. Despite what is stated above, the Licensee may assign its rights under this Agreement, on a bona fide basis, to an Affiliate, without the prior written consent of the Licenser, or to a purchaser of substantially all of the assets of the Licensee if: (i) the assignee executes an agreement with the Licenser to be bound by the terms of this Agreement and agrees to pay the reasonable costs of the Licenser incurred in connection with the preparation, negotiation and finalization of that agreement; (ii) the assignee agrees in the agreement referred to above, that should it cease to be an Affiliate of the Licensee, an assignment in respect of which the Licenser's consent is required as provided above will be considered to occur; and (iii) the assignee provides to the Licenser those reasonable particulars which the Licenser requires in order to satisfy itself concerning the requirements stipulated above, and provides to the Licenser reasonable advance notice to enable it to prepare, negotiate and obtain the execution of the agreement mentioned above and to satisfy itself that the requirements stipulated above are satisfied.
- (b) No assignment whether to an Affiliate or otherwise, shall release the Licensee from any liability or obligation under this Agreement, unless the Licenser provides a release in writing.
- (c) Subject to Schedule "B", except as required or mandated by the CRTC and as provided for in this Agreement, the Licensee will not sublicense, co-locate, share the use of, or otherwise provide the benefit of this Agreement to any TSP and will not mortgage or encumber its rights under this Agreement in favour of any lender without the Licenser's consent.
- (d) Despite what is stated above, the Licensee will be permitted to assign its rights under this Agreement to a bona fide lender, as collateral security for any bona fide, secured financing of all or part of its business undertaking. However, this permission does not imply or allow the inference that the Licenser waives, or is willing to forbear from the exercise of its remedies under this Agreement, should an Event of Default occur, nor that any lender will have any greater rights than the Licensee in respect of this Agreement, including but not limited to the restrictions set out in this Section 17.

18. HAZARDOUS MATERIALS

The Licensee shall not install, bring upon, or use any Hazardous Substance into or on the Building or Lands except telecommunications equipment batteries in a manner and in quantities as necessary for the ordinary performance of Licensee's business in the Building, and provided that any such use is in compliance with all applicable laws. The Licensee shall indemnify and hold the Released Licenser Persons and any party the Licenser is responsible for at law, harmless from any claim, loss, cost, damage, or expense resulting from any breach regarding the installation or

use of any Hazardous Substance brought into or on the Lands or Building by the Licensee or those for whom it is responsible at law, including any and all costs incurred in remedying such breach.

19. EVENTS OF DEFAULT - TERMINATION REMEDIES

- (a) Each of the following events shall be deemed to be an Event of Default by the Licensee under this Agreement:
 - (i) the Licensee defaulting in the payment of any License Fee, Electrical Consumption Fee, or portion thereof, or other sum of money due to the Licenser and such default continues for more than Five (5) Business Days, after written notification of such default by the Licenser to the Licensee;
 - (ii) there is interference with the telecommunications or computer equipment of the Licenser, any tenant, or any other occupant of the Building or any other telecommunications or computer devices provided in the Building by reason of, or as a result of, the installation, operation, maintenance, repair, or removal of the Licensee's Equipment, which interference is not cured within forty-eight (48) hours of the Licensee's receipt of written notice by the Licenser of such interference;
 - (iii) the revocation of the Licensee's permission to provide regulated or non-regulated telecommunications services by any governing entity authorized to permit or regulate the Licensee's providing of such services;
 - (iv) the Licensee's becoming insolvent, or the filing, execution, or occurrence of a petition in bankruptcy or other insolvency proceeding by or against the Licensee; or an assignment for the benefit of creditors; or a petition or proceeding by or against the Licensee for the appointment of a trustee, receiver or liquidator of the Licensee or of any of the Licensee's property or a proceeding by any governmental authority for the dissolution or liquidation of the Licensee;
 - (v) the appointment of a receiver, receiver and manager, or other representative in connection with any default by the Licensee under any loan or debt obligation;
 - (vi) the ceasing of the Licensee to carry on business in the ordinary course; and
 - (vii) if the Licensee shall default in the observance or performance of any of the Licensee's other obligations under this Agreement or any other agreement entered into between the Licensee and Licenser and such default shall continue for more than fifteen (15) Business Days after written notification of such default by the Licenser to the Licensee.
- (b) Upon or after the occurrence of an Event of Default the Licenser may elect to terminate this Agreement without limiting its other remedies.

- (c) If the Licensor shall default in the observance or performance of any of the Licensor's obligations under this Agreement and such default shall continue for more than ten (10) Business Days after written notification of such default by the Licensee to the Licensor or such other period as required to cure the default provided Licensor commences to cure, the Licensee may terminate this Agreement without limiting its other remedies.

20. RESTORATION OBLIGATIONS

- (a) At the expiration or earlier termination of this Agreement the Licensee shall, at the Licensee's sole cost and expense, without liens, remove the Entrance Cable, and all other items of the Licensee's Equipment (and Licensee shall repair all damage caused by such removal) except any part of it that by agreement between the Licensee and the Licensor has been acquired by the Licensor, and all of the Licensee's personal property from the Building. This obligation to remove the Entrance Cable and all other items of the Licensee's Equipment shall be subject to any CRTC-mandated obligations upon the Licensee to provide services to other TSPs. If any property that is required to be removed is not so removed within twenty (20) Business Days after the termination, the property may, at the Licensor's sole option, (i) be removed and stored by the Licensor at the Licensee's expense (and the Licensee will pay an administration fee equal to fifteen percent (15%) of the expense), or (ii) become the property of the Licensor without compensation to the Licensee. As of the date of such removal, neither party shall have any claim against the other, except for claims or obligations that may have arisen or accrued prior to such termination or arise by reason of the Licensee's Equipment and other equipment or property removal, which claims or obligations shall survive such termination. The Licensee further covenants, at its sole cost and expense, to repair or refinish all damage caused by the operation or removal of the Licensee's Equipment. If the Licensee fails to repair or refinish any such damage, the Licensor may, in its sole discretion, repair or refinish such damage and the Licensee shall reimburse the Licensor of all costs and expenses incurred in such repair or refinishing and will pay to the Licensor an administration fee equal to fifteen percent (15%) of the cost. The Licensee will provide to the Licensor upon completion of the removal of the Licensee's Equipment an engineer's report confirming completion of the removal in accordance with this Agreement.
- (b) If due to CRTC mandated obligations upon the Licensee to provide services to other TSPs, the Licensee is not required by Section 20(a) to remove the Entrance Cable or other items of the Licensee's Equipment ("Exempted Items") then despite the expiration or termination of the Term of this License, all of the obligations of the Licensee under this Agreement will continue in full force and effect except that the obligation to pay the License Fee will be suspended so long as the Licensee does not provide Services. That situation will continue (subject to the sentence following this one) until the Licensee's CRTC mandated obligations end and the Licensee removes the Exempted Items and restores damage as provided in Section 20(a). So long as, and to the extent a third party assumes responsibility and control of the Exempted Items, and the third party is bound by a telecommunications access agreement with the Licensor, or a successor of the

Licensor, the Licensee will be exempted from the obligation to remove the Exempted Items.

21. LICENSOR'S ALTERATIONS

Despite anything else in this Agreement, the Licensor may, at any time, make any changes in, additions to or relocations of any part of the Building, may grant, modify or terminate easements and any other agreements pertaining to the use or maintenance of all or any part of the Building, may close all or any part of the Building to such extent as the Licensor considers necessary to prevent the accrual of any rights in them to any persons and the Licensor may also make changes or additions to the pipes, ducts, utilities and any other building services in the Building (including areas used or occupied by the Licensee) which serve any part of the Building. No claim for compensation shall be made by the Licensee by reason of any inconvenience, nuisance or discomfort arising from work done by the Licensor but the work will be done as expeditiously as is reasonably possible.

22. NOTICES

Any demand, notice or other communication to be made or given in connection with this Agreement shall be in writing and shall be deemed received by the recipient on the date of delivery, provided that delivery is made before 5:00 p.m. on a Business Day, failing which receipt shall be deemed to have occurred the next following Business Day. Until notified of a different address, as provided herein, all notices shall be addressed to the parties as stipulated on the Information Page. Notices given by electronic means will not be considered to have been given in writing.

23. LICENSEE'S EQUIPMENT TO REMAIN PERSONAL PROPERTY

Except as otherwise provided in this Agreement, the Licensee's Equipment, Entrance Cable and In Building Wire shall remain personal property of the Licensee although it may be affixed or attached to the Building, and shall, during the Term of this Agreement, or any Renewal Term, and upon the expiration of this Agreement belong to and, subject to Section 20, be removable by the Licensee.

24. LICENSE ONLY

This Agreement creates a non-exclusive license only and the Licensee acknowledges that the Licensee does not and shall not claim any interest or estate of any kind or extent whatsoever in the Building, Communications Spaces, or Equipment Room by virtue of this Agreement or the Licensee's use of the Building, Communications Spaces or Equipment Room. The relationship between the Licensor and the Licensee shall not be deemed to be a "landlord-tenant" relationship and the Licensee shall not be entitled to avail itself of any rights afforded to tenants at law.

25. LIMITATION OF LIABILITY

The obligations of the Licensor under this Agreement shall no longer be binding upon the Licensor if the Licensor or Owner(s) sells, assigns or otherwise transfers its interest in the Building as owner or lessor (or upon any subsequent licensor or owner after the sale, assignment or transfer by such

subsequent licensor). If there is such a sale, assignment or transfer, the Licensor's obligations shall be binding upon the grantee, assignee or other transferee of the interest, and any such grantee, assignee or transferee, by accepting such interest, shall be deemed to have assumed those obligations. A lease of the entire Building shall be deemed a transfer within the meaning of this Section. For greater clarity, nothing in this Section releases the Licensor from any liability(ies) that may arise prior to the date of such sale, assignment or transfer herein.

26. SPECIFIC TERMINATION RIGHTS

In addition to the other termination rights provided to it in this Agreement, either party may elect to terminate this Agreement in each of the following circumstances, subject to giving at least thirty (30) days' prior written notice to the other party:

- (a) where the Building has been destroyed, or damaged to such an extent that it is not feasible to repair it within a period of one hundred and eighty (180) days after the damage;
- (b) where the Deemed Area or the Communications Spaces become damaged and, it is not feasible to restore them within ninety (90) days after the damage;
- (c) where the Building is expropriated by a lawful authority;
- (d) where the Licensor wishes to redevelop, or otherwise alter the Building in such a manner as to, in the Licensor's opinion, make the relocation of any part of the Deemed Area or the Licensee's Equipment not feasible;
- (e) the Licensee no longer provides Services in the Building to any Person;
- (f) the Licensee is unable to secure, on terms and conditions reasonably satisfactory to it, all necessary consents, approvals, permits and authorizations of any federal, municipal or other governmental authority having jurisdiction over the provisioning of Services or any other matters required by the Licensee to provide Services; or
- (g) the Building is no longer a "Multi-Dwelling Unit Building" as defined by the CRTC.

27. ESTOPPEL CERTIFICATES

The Licensee will provide to the Licensor from time to time, within ten (10) Business Days of the Licensor's written request in each case, at no cost to the Licensor, a statement duly executed by the Licensee confirming that this Agreement is in good standing, the Fees payable and the Fees actually paid to any date specified by the Licensor for the statement, the Commencement Date, the Term, any Renewal Term to which it claims to be entitled, and any other information that the Licensor reasonably requests pertaining to this Agreement or Building.

28. NON-LIABILITY

The Licensee acknowledges, covenants and agrees:

Telecommunications License Agreement (POP) 24

- (a) that the Licensor named in this Agreement is the nominee on behalf of RioCan Real Estate Investment Trust (the "Trust"); and
- (b) the obligations being created by this Agreement and any liabilities arising in any manner whatsoever out of or in connection with this Agreement are not personally binding upon, and that resort shall not be had to, nor shall recourse or satisfaction be sought from, the private property of any of:
 - (i) the unitholders of the Trust;
 - (ii) annuitants under a plan of which a unitholder of the Trust acts as trustee or carrier; and
 - (iii) the officers, trustees, employees or agents of the Trust.

29. SEVERAL OBLIGATIONS - NON-RECOURSE

The liability of each of the Owner(s) where there are more than one, is several and not joint, or joint and several and is limited to the interest of the Owner(s) from time to time in the Building.

30. ENTIRE AGREEMENT

The terms and conditions contained in this Agreement supersede all prior oral or written understandings between the parties and constitute the entire agreement between them concerning the subject matter of this Agreement. This Agreement shall not be modified or amended except in writing signed by authorized representatives of the parties.

31. LICENSEE'S REPRESENTATION

The Licensee represents to the Licensor and acknowledges that the Licensor relies upon this representation and would not have entered into this Agreement but for that representation, that, the construction, design and operation of the Licensee's Equipment includes back-up, redundant and "fail safe" features so that the risk of damage, malfunction or disruption of the Licensee's Equipment disrupting service to customers or other third parties utilizing that network and equipment (except for telecommunication services between (i) the customers of the Licensee or the customers of telecommunication service providers that lease local loops from the Licensee to serve customers within the Building and (ii) persons communicating with those customers) is minimized.

32. FORCE MAJEURE

Without limiting or restricting the applicability of the law governing frustration of contracts, in the event either party fails to meet any of its obligations under this Agreement within the time prescribed, and such failure shall be caused, or materially contributed to, by force majeure, such failure shall be deemed not to be a breach of the obligations of such party under this Agreement, and the time for the performance of such obligation shall be extended accordingly as may be appropriate under the circumstances. For the purpose of this Agreement, force majeure shall include, but is not limited to: any acts of God, war, natural calamities, strikes, lockouts or other labour stoppages or disturbances, civil commotion or disruptions, riots, epidemics, acts of

government or any competent authority having jurisdiction, or any other legitimate cause or event beyond the reasonable control of such party, and which, by the exercise of due diligence, such party could not have prevented, but lack of funds on the part of such party shall not be deemed to be a force majeure.

33. IMPLIED WAIVERS

A waiver by the Licensors or the Licensee of any breach of the terms, covenants and conditions of this Agreement shall not be deemed to be a waiver of the term, covenant or condition or of any subsequent breach of it or any other term, covenant or condition. No term, covenant or condition of this Agreement is deemed to have been waived unless the waiver is in writing and signed by the Licensors or the Licensee, as the case may be.

34. SEVERABILITY

If any provision of this Agreement or any part of a provision is found to be illegal or unenforceable then it will be severed from the rest of this Agreement and the rest of this Agreement will be enforceable, accordingly.

35. GOVERNING LAW

This Agreement will be governed by the laws of the province in which the Building is situated.

36. AUTHORITIES OF ACTION

Licensors may act in any matter provided for herein by its property manager and any other person who shall from time to time be designated in writing by Licensors to Licensee. Licensee acknowledges that if this Agreement has been executed for and on behalf of, in name of and with the authority of Licensors by the property manager then the covenants and agreements of Licensors are obligations of Licensors and its successors and assigns only and are not obligations personal to or enforceable against the property manager in its own right.

IN WITNESS WHEREOF, the Licensors and the Licensee have executed this Agreement in multiple original counterparts as of the day and year first above written.

**RIOCAN MANAGEMENT INC., as agent for
RIOKIM HOLDINGS (ONTARIO) INC.**
(Licensor)

Per: 
Yuriy Koval (Nov 16, 2023 16:13 EST)
Name: Yuriy Koval
Title: AVP, Procurement & Business Optimization, Procurement

Per: 
Oliver J Harrison (Nov 16, 2023 16:36 EST)
Name: Oliver Harrison
Title: SVP, Leasing & Tenant Experience, Corporate

I/We have authority to bind the corporation

BELL CANADA
(Licensee)

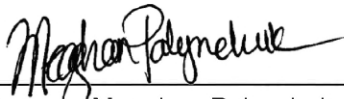
Per: 
Name: Meghan Palynchuk
Title: Senior Specialist, Asset Manager

Per: _____
Name:
Title:

I/We have authority to bind the corporation

SCHEDULE “A”

DEEMED AREA

Licensee Deemed Area submissions attached.

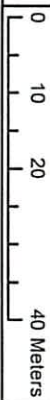
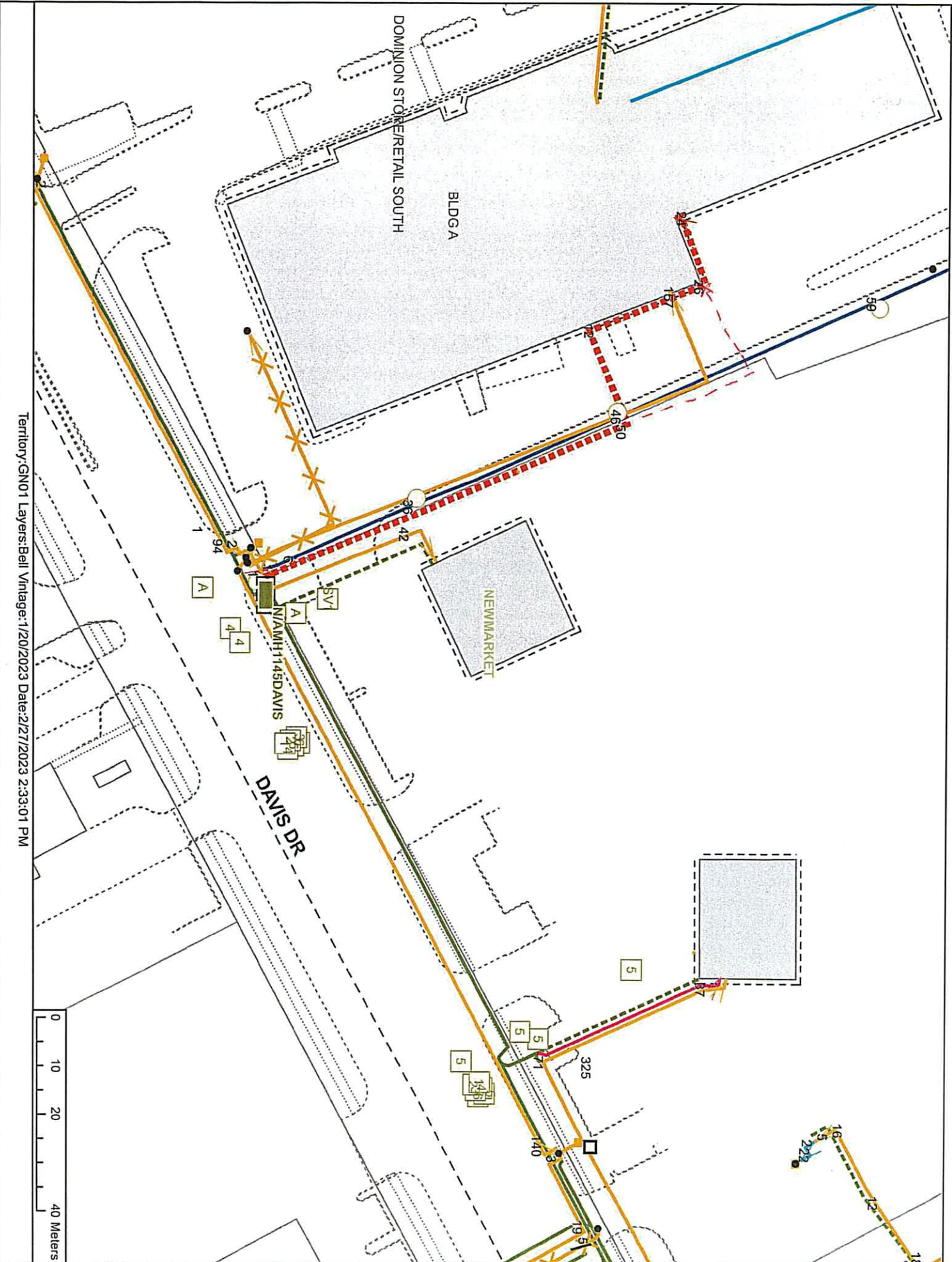



PIT,
RECD

BORE
22 m





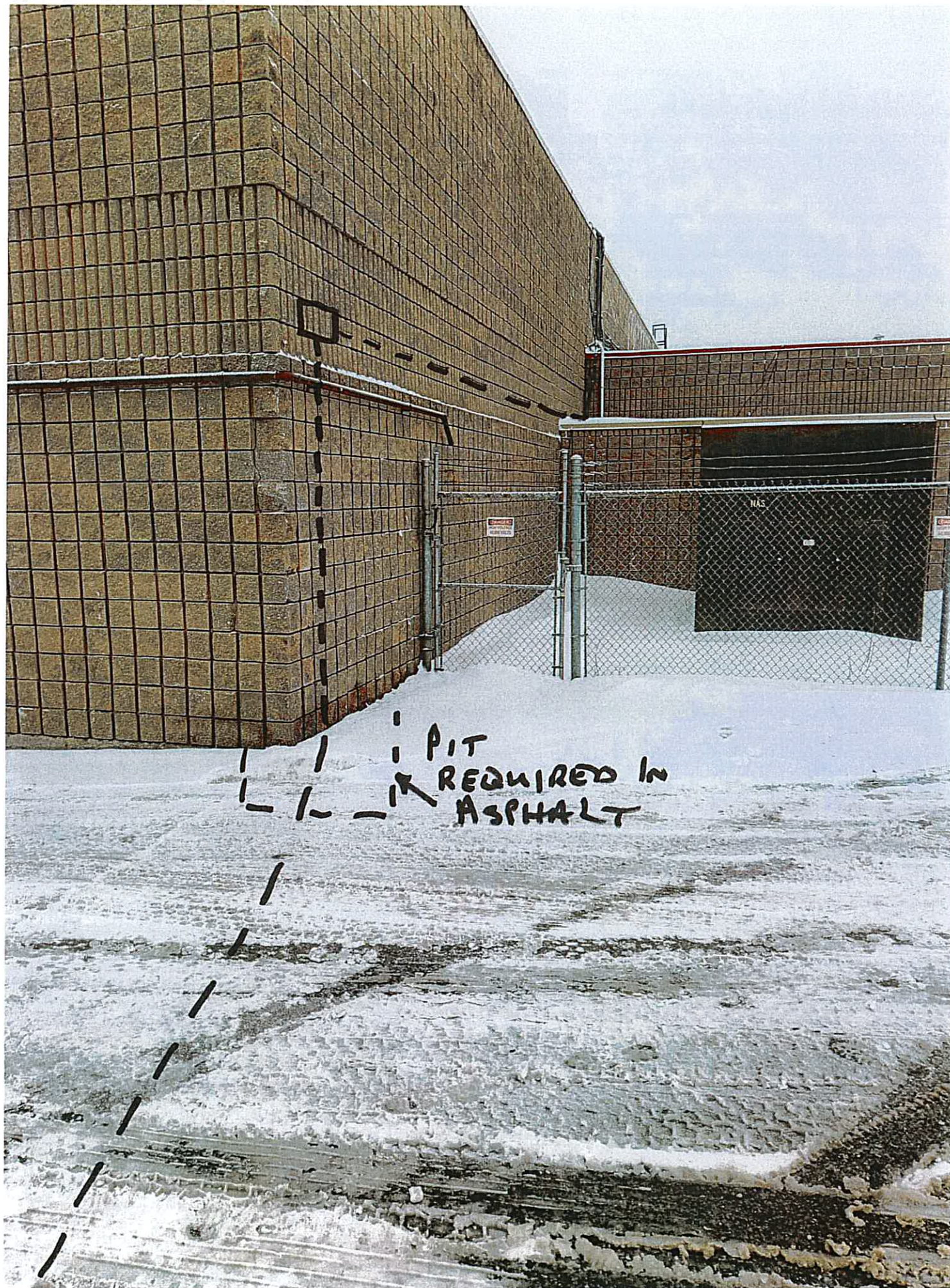



SCHEDULE "B"

CO-LOCATION

In this Schedule "B" the following definitions apply:

"Co-location": a sharing of space resulting from relocation permitted by this Schedule "B" of Related Party Equipment or Communications Equipment.

"Combined Area": the total floor area occupied by the Deemed Area or the Related Party Space after a Co-location.

"Corporate Change": a corporate reorganization, amalgamation, merger, acquisition, divestiture or other corporate asset change, structural or organizational change involving the Licensee or a Related TLA Party where the change becomes effective after the date of this Agreement and the Related TLA Party is an Affiliate of, becomes an Affiliate of, or is merged or amalgamated with the Licensee.

"Minimum Area" : the minimum area upon which the annual License Fee is based under this Agreement, or upon which the TLA Fee is based if, in either case, the actual floor area of the Deemed Area or the Related Party Space is less than the minimum area.

"POP Room Equipment": cabinets, racks electronic equipment, panels and other equipment intended to provide telecommunications services to tenants and occupants of the Building.

"Related Party Equipment": POP Room Equipment owned by a Related TLA Party and installed in Related Party Space.

"Related Party Space": space leased or licensed to a Related TLA Party to house Related Party Equipment.

"Related TLA Party": a corporation, other than the Licensee, that is bound by a TLA and is involved in a Corporate Change.

"TLA" an agreement with the Licensor, or the Owner(s) under which a licensee or tenant is permitted to operate or install POP Room Equipment in a Related Party Space.

"TLA Fee": the annual minimum or basic license fee payable under a TLA for use of space in a building.

If, as the result of a Corporate Change, the Licensee determines that the Communications Equipment, or that Related Party Equipment is redundant, then the Licensee, on at least thirty (30) days written notice to the Licensor may:

- (a) at its cost, relocate the Communications Equipment to the Related Party Space, or permit the Related TLA Party to relocate its Related Party Equipment to the Deemed Area;

- (b) terminate this Agreement; or
- (c) if the Licensee has become the licensee or tenant under the TLA, terminate the TLA between the Licensor and the Related TLA Party.

If a Co-location occurs, all costs reasonably incurred by the Licensor to alter the Building space, facilities or equipment to accommodate the Co-location will be recoverable by the Licensor as Recoverable Costs. The Deemed Area or the Related Party Space will only be increased in size or reconfigured if appropriate space is available in the Building. On the occurrence of a Co-location, the Licensee will no longer have any right to occupy the Deemed Area, unless the Related TLA Party gives up its right to occupy the Related Party Space.

On the first day of the month following the month in which a Co-location occurs, the License Fee may, at the Licensor's option, be adjusted as follows:

- (i) if the both the License Fee and the TLA Fee are based on Minimum Areas, and the Combined Area is sixty (60) square feet or less, the License Fee will be increased so that it is based on sixty (60) square feet but so long as the TLA Fee, based the Minimum Area under the Related TLA Party continues to be paid it will be credited against that License Fee;
- (ii) if Related Party Equipment is relocated to the Deemed Area and the Combined Area is greater than sixty (60) square feet, then the Combined Area may be reduced by thirty (30) square feet for the calculation of the License Fee, so as long as the Related TLA Party pays a TLA Fee based on at least thirty (30) square feet; or
- (iii) if the Communications Equipment is relocated to the Related Party Space and the Combined Area is greater than sixty (60) square feet, then the License Fee will be calculated on only thirty (30) square feet as long as the TLA Fee is calculated and paid based on the Combined Area less thirty (30) square feet.

If this Agreement is terminated or the TLA with the Related TLA Party is terminated, then the License Fee or the TLA Fee, as the case may be, will be adjusted if necessary so that it is calculated on at least sixty (60) square feet.

SCHEDULE C
CONNECTING EQUIPMENT

Licensee Connecting Equipment drawings attached.

Codes, Standards & Guidelines.

Telecommunications License Agreement (POP) 31

TYPICAL LAYOUT FOR FTTB Belden FX UHD Wall Mount FPPA48 INSIDE TERMINAL

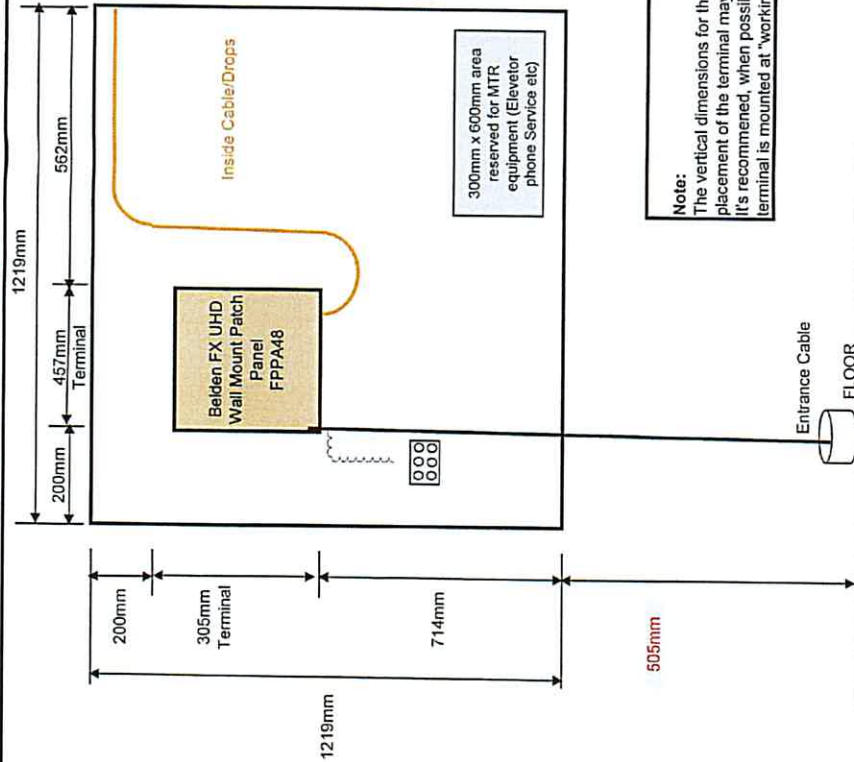

FTTB - BELDEN FX UHD FPPA48 Terminal Specifications		
Item	Description	
Configuration	Wall	
Height	305mm (12")	
Width	457mm (18")	
Depth	165mm (6.5")	
Connectors	SC APC/UPC	

BELDEN FX UHD WALLMOUNT Patch Panel Reference:

BCP 631-4452-107: FX UHD Wall Mount Patch Panel Description and Installation Guide

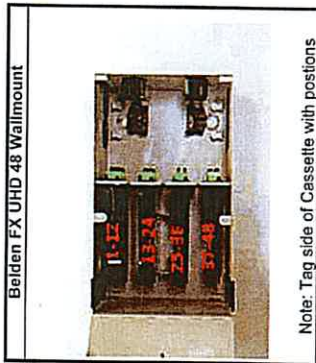

QTY	Material	Sort Code	Comments
	TERMINAL FX UHD 48F WALLMOUNT	080099NM	48F FPPA used as an indoor terminal (FTTB)
	**CASSETTE FX UHD 12F RIBBON/SCAPC/FTTS/B	080100NM	ICING CASSETTE WITH 12-FIBRE RIBBON SCAPC FAN-OUT
	CASSETTE FX UHD 12F 0.9/SCAPC/FTTS/B	080101NM	splicing cassette with 12 SCAPC 900-micron pigtails
	CASSETTE FX UHD 12F RIBBON/SCAPC/FTTS/B	083383NM	splicing cassette with 12-fibre ribbon SCUPC fan-out
	**CASSETTE FX UHD 12F 0.9/SCUPC/Mega	083384NM	splicing cassette with 12 SCUPC 900-micron pigtails

Note: ** = Minor Material

Notes:

Place 6 post Ground Bracket and tag

Place yellow tag identification

Connect ground to:

Ground Location:

Ground Wire Length:

Copy of plan to be left at terminal location

All changes to design must have the consent of the originator

Additional Details:

CAUTION!
OBSERVE SAFETY PRECAUTIONS
BELL

BUILDING ADDRESS:

ON SITE CONTACT NAME:

ON SITE CONTACT NUMBER:

ON SITE CONTACT EMAIL:

ORIGINATOR / IM

PHONE

EXCHANGE

SC

NETWORK #

PLAN #

DESIGNER NOTES:
TYPICAL PLAN, NOT TO SCALE (ALL MEASUREMENTS IN MM)
DO NOT FORGET 3M RULE, AND IF APPLICABLE WITH INSULATING JOINT

plywood

411

STOP

STOP



m712

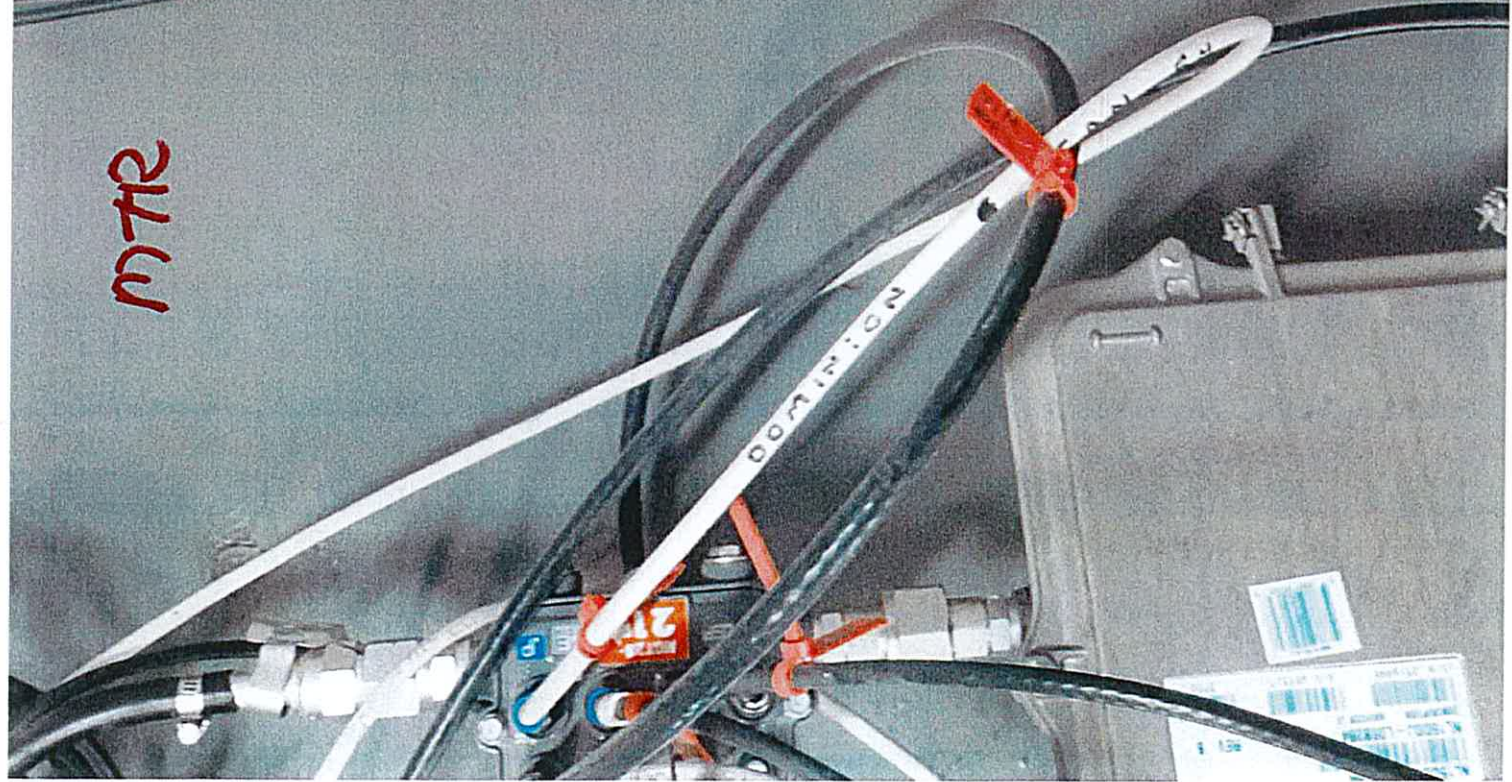

Untitled Map

Write a description for your map.

Legend

1111 Davis Dr

Box

Box

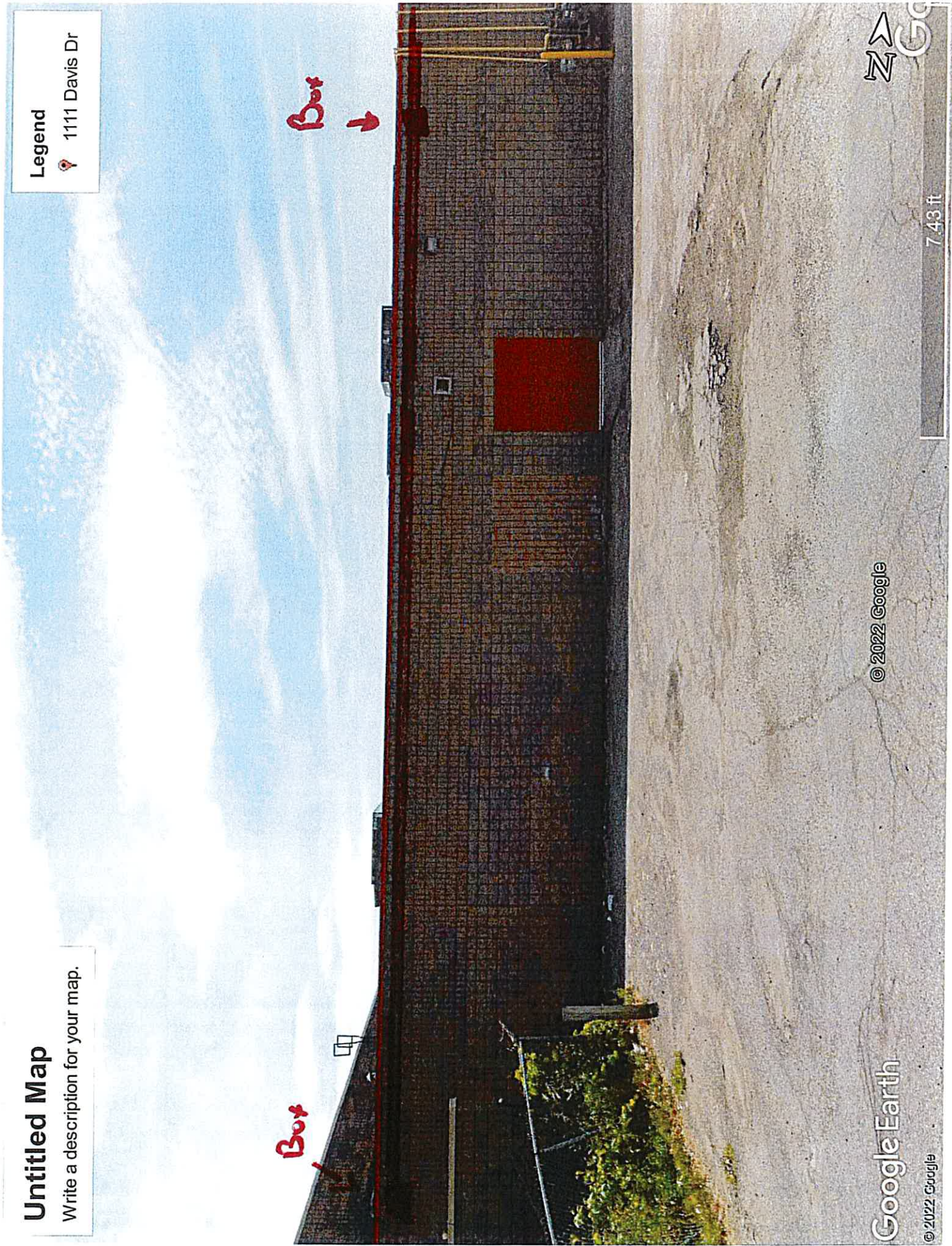

Google Earth

© 2022 Google



© 2022 Google

7.43 ft

Untitled Map

Write a description for your map.

Legend

1111 Davis Dr

box

Google Earth

© 2022 Google

6.25 ft



Untitled Map

Write a description for your map.

Legend



1111 Davis Dr



Google Earth

© 2022 Google

6.77 ft



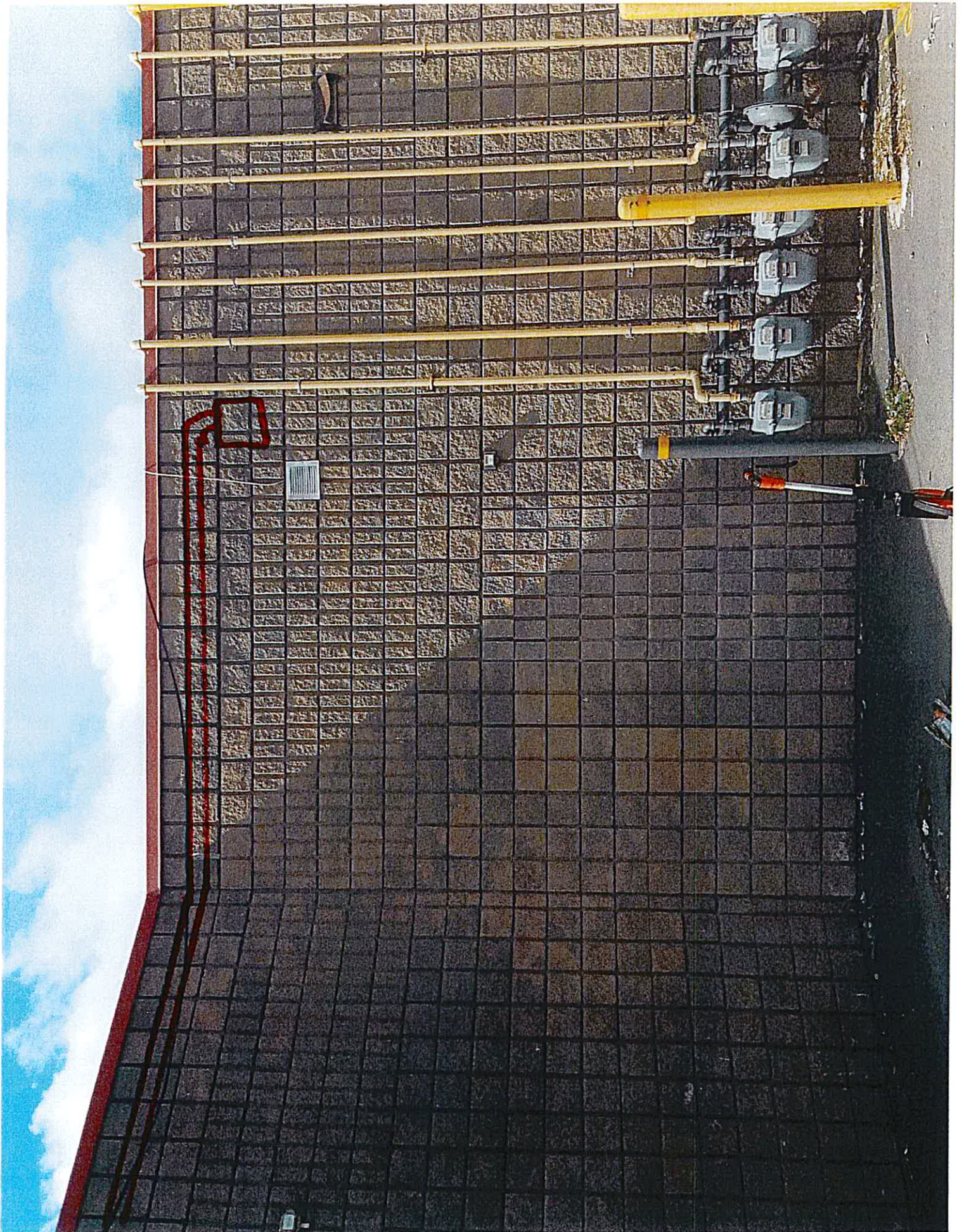



All telecommunication work performed within the Building must conform to [ANSI/TIA/EIA](#) telecommunication cabling standards, Ontario Electrical Code (OEC) , [National Fire Protection Association](#) (NFPA) and [Occupational Safety and Health Administration](#) (OSHA). In addition to these codes and standards, contractors must use industry best practices as published by [BICSI](#) and follow the most current release of the [Telecommunication Distribution Methods Manual](#).

Although not mandatory, it's recommended that the designer who is putting together the designs of the telecommunication infrastructure is a BICSI certified RCDD and in good standing. Should the designer not have an RCDD a minimum requirement of 5 years of design experience is needed in order to design and submit drawings to the Licensor.

Outside Plant work which details conduits and telecommunication cabling outside of the Building is the responsibility of the Licensee to design, engineer, and obtain permits. Final Entrance Facility location must be reviewed and approved by the Licensor. The contractor designing the work shall provide all drawings to the Licensor for comment and review. Drawings will be reviewed at current billable rate.

1.0 Pathways

Pathways are spaces that allow telecommunication cabling to run from a source to a destination location. These spaces consist of conduit and sleeves. Pathways can be installed through parking levels, concourse levels, lobbies, riser rooms, and common areas. Listed below are the specific requirements for pathways within the Building:

- 1.1 Telecommunication cabling shall be installed within conduit located within the parking garages, concourse levels, and common areas extending from the riser room to a tenant suite. Cabling is permitted to be run free air within the riser space provided that best industry practices are followed and the installation conforms to section 2.0 Cabling. It should be noted that any damage done to a cable running free air within the property shall be the responsibility of the owner to fix and replace. the Licensor will not be held responsible for any damages done or revenues lost.
- 1.2 Should a Customer or the Licensee want to install conduit within the riser it should be reviewed and approved by the onsite Riser Manager. It is recommended that the conduit is sized for the expected growth and not just the smallest or largest sized conduit installed.
- 1.3 Conduits, connectors, couplers, pull boxes, and covers that are located in the parking garage area and throughout other common visible areas must be painted powder coat white. This must be done offsite, and no other form of paint will be accepted.
- 1.4 When conduits are running horizontal, labels shall be placed approx. every 15 linear feet. (examples would be through the parking garage area)

- 1.5 Conduits and cabling must be labeled on both sides of each wall, floor penetration, and at both ends of a termination point.
- 1.6 Conduits running vertically in the riser system shall be labeled near the top, in the middle at eye level and one near the bottom close to the core hole. This label will provide a means of quick and accurate identification.
- 1.7 Labels shall clearly identify the ownership of the conduit. The Licensor recommends that additional items such as source and destination locations as well as a contact phone number are included.
- 1.8 Any pre-existing conduits that are not currently labeled and have a single ownership should be labeled with the company who owns the pathway. Common pathways with multiple ownerships do not need to be labeled.
- 1.9 Any type of x-raying, scanning, or coring must have a permit which is assigned by the Licensor's project management team. All concrete structures require x-raying prior to any core drilling taking place. If the Licensee decides to use a preferred contractor of the Licensor for this work, then the x-ray and coring can take place in the same night. No cutting of the structural steel and/or rebar shall be permitted or tolerated. The Licensee or its contractor is to have available on request a copy of the x-ray for the Licensor's representative to review.
- 1.10 It's the Licensee's responsibility to insure that all vertical and horizontal holes their pathway and/or cabling passes through is correctly firestopped.
- 1.11 Where the cabling enters into a conduit or connector it's the contractor's responsibility to provide firestopping of the conduit as well as the hole the conduit passes through the fire rated wall.

Cabling

Telecommunication cabling allows a service to be transported from a source to a destination location. These cables primarily come in copper and fibre and can be shielded or unshielded with different fire ratings.

- 2.1 All telecommunication cabling running free air within a plenum or non-plenum space shall have a minimum fire rating of FT6. This includes both tenant and riser space. Cabling that is routed within conduit for the entire length can have a minimum fire rating of FT4.
- 2.2 Telecommunication cabling entering from the street and into the building is typically unlisted cabling. There are (2) statements that the Licensee must meet in order to route there unlisted cabling from the point of entry to their POP facilities.
 - 2.2.1 If the entry point (source location) of the unlisted cabling is located within the same room as the destination location, the unlisted cabling can be free

aired over to the destination without the need for conduit provided that the room is sealed off and has a minimum 1 hour fire rating.

2.2.2 If the entry point (source location) of the unlisted cabling is located in a different room or the room is not sealed and / or doesn't contain a minimum 1 hour fire rating the Licensee is allowed by the Ontario building code to only have 3 meters of exposed unlisted cabling installed. The cabling can be extended to the destination location provided that the unlisted cabling is completely encased within conduit or a splice can is installed to transition from unlisted to a minimum FT6 fire rated cable.

- 2.3 Telecommunication cabling servicing rooftop antennas or devices located external to the building shall be Outside Plant Rated (OSP). If the OSP cable has an FT4 or lower fire rating it shall be encased within conduit for the entire length.
- 2.4 Copper cabling or conductive cabling entering the building from the outside shall be bonded to ground and copper pair cabling shall contain a surge protector. All dielectric non-conductive cabling does not require surge protection or bonding.
- 2.5 Shielded cabling should be bonded to ground.

3.0 Spaces

Spaces are places where telecommunication gear is located. This gear can include accumulation panels, passive equipment, active equipment, the Licensee gear, tenant telecommunication rooms or tenant gear.

- 3.1 No active components requiring electrical power shall be permitted to be installed within the riser rooms. These spaces are meant to be common, and are to house equipment and components that serve base building systems and deliver Telco services to the tenants.
- 3.2 The Customers will only be permitted to install demarcation extension cables inside riser rooms or to gain access to the cellular floor system. Under no circumstances shall a Customer be permitted to install or terminate any station cabling within these riser rooms or place active gear.
- 3.3 the Licensee is permitted to set up Point-Of-Presence (POP) spaces within the Building. These spaces require design drawings from an engineering firm. The Licensee that is setting up these spaces is required to contact the base building Riser Manager, to perform site review services. These site review services are billable back to the Licensee at current rates.
- 3.4 Consultants and designers are required to obtain the services of the Riser Manager any time a piece of hardware is to be installed or mounted within the riser room. The Riser Manager will provide written documentation notifying of our recommendations and find and assign the correct amount of space required. These site review services are billable at current rates.
- 3.5 Any installations passing vertically through more than (4) floors require a set of drawings that will be reviewed and approved by the riser manager, prior to any work being conducted.
- 3.6 Cabling installations requiring site reviews will be inspected by and are billable at current rates.
- 3.7 In addition to the codes and standards listed within this schedule, the Telecommunications License Agreement and the lease with the Customer are in effect and form part of this document.

SCHEDULE "D"

RECOVERABLE COSTS

The Recoverable Costs are the costs of:

- (a) architectural, mechanical and electrical consulting fees to provide or review architectural, electrical and heating, ventilating and air-conditioning design for construction of additional main terminal room or point of presence space (Equipment Room space), riser rooms and other areas requiring reconstruction to accommodate the installation of the Licensee's Equipment;
- (b) mechanical engineering and construction to provide any additional cooling for anticipated loads to accommodate the Licensee's requirements;
- (c) electrical engineering and construction to provide sufficient power distribution to support the power loads anticipated for the Licensee's Equipment, including any connection to any emergency generator power grid that may be made available using a transfer switch;
- (d) the installation of any secured entry devices or other mechanical or electronic security devices that may be installed to satisfy the requirements of the Licensee;
- (e) construction for additional space or reconstruction or modification of existing space to accommodate the Licensee and modifying, enlarging or enhancing any telecommunication related facilities that must be made to accommodate the requirements of the Licensee including the reviewing of plans, specifications and working drawing and the monitoring of the performance of work and the obtaining of professional advice from engineers and technical experts;
- (f) any other reasonable costs of facilitating the initial set up of the Licensee's operations within the Building; and
- (g) reviewing plans, specifications and working drawings and monitoring performance of work as contemplated by Section 7(a) except that, regardless of what is provided in Section 7(a) of this Agreement, no charge will be made for reviewing plans, specifications or working drawings, for (A) installation of cable between a point of connection in riser room, or riser and the customer's premises on the same floor as the point of connection; or (B) installations or alterations of cable (sometimes referred to as "adds, drops or changes") for any particular customer within its premises.

SCHEDULE "E"

SCOPE OF WORK

Licensee Scope of Work description attached. Licensee Scope of Work requirements outlined below.

The Licensee shall repair all openings made by the Licensee on the fascia to ensure no water, rodents or insects can enter the building.

The weatherhead on the east side of the building face should be clearly labeled with both the Licensee's name and service contact phone number. It's the Licensee's responsibility to provide their field technicians or contractors with the appropriate labels that will last through all (4) seasons of a typical year for outdoor installation work.

The transition point between outside plant and inside plant cabling contains a surge arrestor. This will be a requirement of the Licensee to implement.

During construction, security guard escorts may be required by the Licensor. If a security guard escort is required, it will be the responsibility of the Licensee to make the appropriate arrangements prior to any work commencing on site.

All of the Licensee's infrastructure shall be labeled. At a minimum, the labeling shall contain the Licensee's name and be placed within 15' intervals. Labeling shall be placed on either side of walls where the conduit / cable penetrates through. Increasing labeling accuracy is of a high importance to the property. The label must contain both the originating and destination locations of the cabling / conduit.

Free Aired cabling routing horizontally or vertically shall be supported to meet TIA/EIA telecommunication cabling standards. Cabling is to be supported between 4 to 5 feet.

Damaging of building finishes caused by Licensee will be the responsibility of the Licensee to repair at their sole cost, reasonable wear and tear excepted. Examples of such damage would include but not limited to the installation of an access panel within a drywall ceiling area which hasn't been approved by the Licensor, damage to the fascia etc. The Licensee is to have their contractor wear clean gloves when opening up accessible ceiling titles to avoid messy hand prints on the ceiling titles.

Conduit and cabling shall be kept parallel to building lines and installed in a good, workmanlike manner.

Cutting and coring shall be completed by the Licensor's approved cutting and coring supplier. Some buildings require a structural engineer to review the scan or x-ray prior to cutting of the

structure. The Licensee shall review the Licensor's building procedures and consult the Licensor's construction manuals.

Any electrical work that is required must be carried out by a qualified and licensed electrical contractor / individual.

The Licensee shall ensure that any penetrations made through fire separation walls are fire stopped. It's the Licensee's responsibility to ensure that firestopping is replaced.

The Licensee shall properly dress the cables in each riser

The Licensee shall try to the best of their abilities to keep the cabling running to one side of the vertical riser space and try to use the same vertically stacked core hole all the way up the riser system.

The Licensee shall ensure that the risers are left in "as is" condition or better (eg. no garbage)

It's the Licensee's responsibility to carry out the intended scope of work in a safe manner for themselves and occupants of the building. Contractors shall conduct the work to conform to the Building Code, Electrical Code, OSHA, Licensor's construction manual, Published Telecommunication standards and industry best practices.

Dwayne Lubin

From: Parolin, Jane <Jane.Parolin@bmo.com>
Sent: March 2, 2023 12:01 PM
To: Dwayne Lubin
Subject: Branch modernization | BMO Davis Drive | Transit 3956 - PAPAD000731
Attachments: PAPAD000731 - Ipact 1083-113 Underground Path Survey Pictures - BMO - 1111 Davis Dr New Market ON.pdf

Importance: High

Follow Up Flag: Follow up
Flag Status: Flagged

Good morning, Dwayne.

We have asked Bell to review once again in order to find an **underground option to bring the fibre cable to the main telephone room** (MTR) and they have presented the following solution:

SCOPE OF WORK:

- Directional Bore 3 inch HDP conduit from pole to pit in grass 22 meters.
- Bore will cross existing utilities and will require a Hydro-Vac to locate.
- Hydro-Vac pits to be backfilled with dirt trucked in
- From pit, directional bore across driveway to building - 17 meters.
- Excavate pit in asphalt at building (4' x 4') to accept bore.
- Backfill pit and re-instate asphalt
- Bring conduit up 3 meters on outside of building and install 12" x 12' x 8" PVC pull box.
- Extend 11 meters of 2 inch PVC conduit on outside wall from pull box to MTR
- Core drill 2" hole through outside wall and extend conduit into MTR.
- Access required to fenced transformer area. (by Landlord)

NOTES:

Work to be completed during regular hours Monday to Friday 9:00 am to 5:00 pm

Please review and provide your approval in order to begin work on the Davis Drive location.

Jane Parolin | Release & Deployment Canada | Network and Data Centre Operations
BMO Financial Group | 4100 Gordon Baker Road, 4th Floor | Scarborough, ON M1W3E8
[P] 416-502-5900
[E] jane.parolin@bmo.com
Visit us at www.bmo.com

We're here to help.

This email and its attachments are confidential. Any unauthorized use or disclosure is prohibited. If you receive this email in error, please notify me by reply email and permanently delete the original without making any copies or disclosing its contents

From: Dwayne Lubin <DLubin@riocan.com>
Sent: February 2, 2023 8:25 PM
To: Parolin, Jane <Jane.Parolin@bmo.com>
Subject: FW: Branch modernization | BMO Davis Drive | Transit 3956 - PAPAD000731

Hi Jane,

In further discussions with regional management we will not proceed with the option of the overhead fibre cable drop from the hydro poles to the building. If the Bell team cannot find an underground option for bringing the fibre cable to the main telephone room (MTR), then we cannot support the service upgrade proposal at this time.

Dwayne Lubin

From: Parolin, Jane <Jane.Parolin@bmo.com>
Sent: November 17, 2022 12:55 PM
To: Dwayne Lubin
Subject: Revised || Branch modernization | BMO Davis Drive | Transit 3956 - PAPAD000731:
Attachments: PAPAD000731 - Impact 1083-113 Updated Survey Pictures - BMO - 1111 Davis Dr New Market, ON..pdf

Importance: High

Good afternoon, Dwayne.

Bell has submitted a revised scope for your review and approval:

SCOPE OF WORK:

- Supply and install a conduit pathway from the main telephone room (MTR) located back of plaza to BMO unit utilizing exterior walls and NOT roof.
- Install 120 meters of 1 1/2" PVC conduit on exterior walls and roof of building from MTR to customer's unit.
- Terminate conduit in two 12" x 12" x 8" PVC junction boxes on the external walls at either end.
- Core through junction boxes and external walls and sleeve to access MTR and BMO unit respectively.
- In the MTR - Core drill 2" hole and sleeve for incoming Aerial fiber.
- Two additional pull boxes will be required along the route.
- In BMO, supply and install 10 meters of 1 1/2" EMT conduit from junction box above drop ceiling to existing cabinet.
- Supply and install 2x2 fire rated plywood backboard
- Install pull rope in all new conduits.
- Bucket truck required

NOTES: Work to be completed during regular hours Monday to Friday 9:00 am to 5:00 pm

Jane Parolin | Release & Deployment Canada | Network and Data Centre Operations
BMO Financial Group | 4100 Gordon Baker Road, 4th Floor | Scarborough, ON M1W3E8
[P] 416-502-5900
[E] jane.parolin@bmo.com
Visit us at www.bmo.com

We're here to help.

This email and its attachments are confidential. Any unauthorized use or disclosure is prohibited. If you receive this email in error, please notify me by reply email and permanently delete the original without making any copies or disclosing its contents

From: Dwayne Lubin <DLubin@riocan.com>
Sent: November 16, 2022 3:58 PM
To: Parolin, Jane <Jane.Parolin@bmo.com>; Papaliakos, Dianna <dianna.papaliakos@bell.ca>
Cc: Aka Kathe, Fulgence <fulgence.aka_kathe@bell.ca>; Tony Stevens <tostevens@riocan.com>; Beshay, Nashat <nash-at.beshay@bell.ca>
Subject: RE: Branch modernization | BMO Davis Drive | Transit 3956 - PAPAD000731:

Good Afternoon,

Following up on the email chain below, the current scope was not approved for conduit and pull boxes being added to the roof... Although I do have a better understanding of the scope, any and all installation must remain off of the building's roof.

Sorry for any previous confusion.